

The Earl Arts Centre

Located in Launceston's Central Business District



10 Earl St
C/- Princess Theatre
57 Brisbane St
LAUNCESTON TAS 7250
Ph: 03 63310052
E-mail: admin@theatrenorth.com.au
www.theatrenorth.com.au

Updated: June 2018

Capacity:

The Earl Arts Centre is licensed to hold 260 people, (including staff, performers & crew).

The seating plan is for 186 seats. Seating is theatre style seating. See attached drawings for seating. Contact the venue for full details.

Booking Office:

The theatre has its own booking office located within the Princess Theatre. Its direct line is 03 63310052 e-mail

boxofficemanager@theatrenorth.com.au

Hirers can use our box office or the agency of their choice.

Performance Area:

The Earl is a space 20 metres by 13 metres.

Performance area 9.6m wide x 9.7m deep approx

Stage surface flat wooden floor mounted on resilient pads. Stage surface painted. Standard colour is with Dulux X10 Low sheen black.

The Stage is NOT to be painted by Hirers.

There are NO flies.

All theatre walls are black painted concrete block and 50 percent is covered with black curtains on continuous tracking.

Performance grid height 6m

White Cyclorama 6m x 13m

Lighting Equipment:

5 Lighting bars 43mm tube, wired to patch room.

Height 6m from stage floor Fixed Equipment:

2 lighting bars motorised Height 5.5m from stage (Bars 3 and 4)

Lighting Desk: Strand Classic Pallet 228 channel 32 subs

All lighting outlets through full patch board

48 x 2.4 Kw dimmers

16 x 1.2k Selecon SF Fresnel's with barn doors

6 x 1.2k Selecon PC with barn doors

12 x 1k 23° /50° Selecon Pacific Profile

14 x 650 watt Phida Fresnel's (with barn doors)

4 x 650 watt Selecon Acclaim Profiles 24° – 44°

10 x 650 watt Selecon Profiles Zoom Spot 24° – 40°

16 x Par 64 MFL

The lighting bars have a safe working load (SWL) of 250kg

Sound Equipment:

Control:

DIGICO S21 Digital audio Desk 24 inputs 12 outputs
With Digico D-Rack 32 inputs 16 outputs (on request)

PA:

2 x JBL EON 15P Music Mix powered speakers FOH
2 JBL Fold Back speakers and Amp
Sony 5 stack CD player
Sony double cassette deck
2 microphone stands with boom arms & 2 JBL microphones
Induction Loop

Jands Ezicom, Outlets at prompt, opposite prompt, sound and lighting,
back wall up stage and patch bay. Headsets and belt pack available on
request.

3 Phase power:

1 x 3 phase 32A outlet Located in the patch bay

Audio Visual:

- 1 12 x 9 fast fold screen front and rear screens, leg and full drape kit
- 1 Sony ultra wide data projector 3000 lumens with flying brackets
- 1 Sanyo data projector 15000 Ansi Lumens
(Cost to the hirer \$600)

Front of House & Technical Staff:

Hirers need to provide their own Technical and FOH staff. Volunteer FOH staff **MUST** have a briefing with Theatre Management before working any performances/events.

Princess Theatre casual staff is available at cost to the Hirer, contact Theatre Management e-mail theatrenorth@theatrenorth.com.au

The Princess Theatre Tech Manager e-mail techmanager@theatrenorth.com.au

Please note that visiting production crews **MUST** have a technical briefing prior to the commencement of the hire.

Pianos:

One 3/4 Alex Steinbach Grand, model SG 225

One upright Steck

One Steinway Grand (only available by negotiation) Note:

Charges apply for piano hire and tuning

Dressing Room:

2 dressing rooms (with toilet) at stage level
Total accommodation 6
Dressing rooms have hand basins.

Foyer Space:

Is suitable for small functions and can be used as an exhibition space.
Fridge and wash up area
Track lighting is positioned around the walls
Wall height 2930mm

Loading Bay:

Access is at truck tray level off Earl Street.
Earl Street Access door 2.4m by wide 3m high.
Sound Proof Door Scenery access door 2.4m x 2.4m.
Loading bay shared with the Princess Theatre via a

The Sound proof door is only to be opened for bump in and bump out

Testing and Tagging:

The Princess Theatre adheres to Australian Standard AS/NZS
3760:2003 In-service

Note: All electrical appliances and power leads should be tested tagged with current inspection and due date, prior to being brought onto the premises.

Stage Fire Precautions:

Any scenery, props, masking, Costumes etc must be rendered non flammable to the approval of Princess Theatre Management.

Chubb Fire sells a spray on Fire Retardant for Fabric

For a Virtual Tour of the Earl Arts Centre and Princess Theatre include loading bay access please follow the link below (please note this tour show the old seating configuration in the Princess Theatre)

<http://frontiermultimedia.com/wp-content/uploads/princess/tour.html>

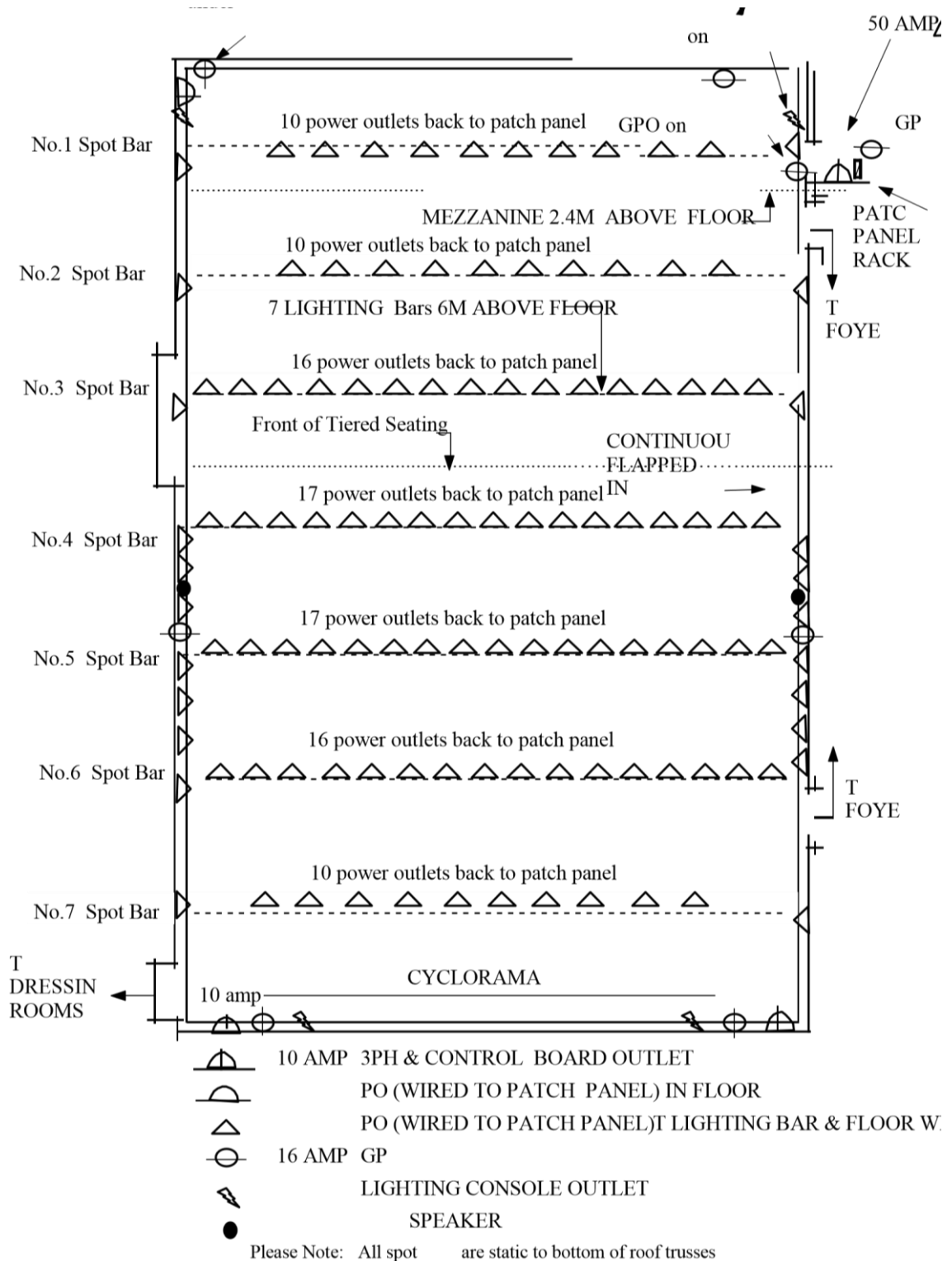

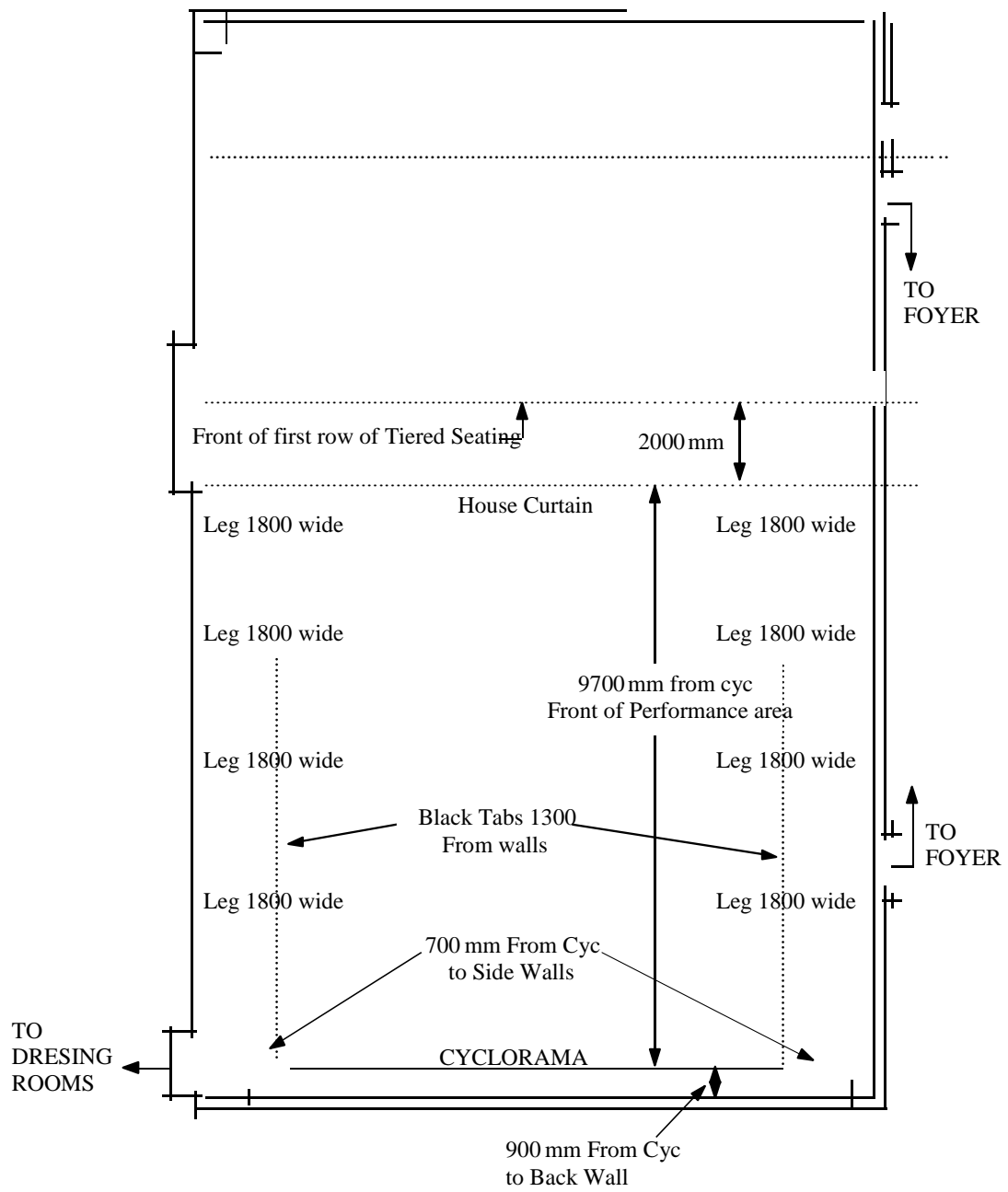

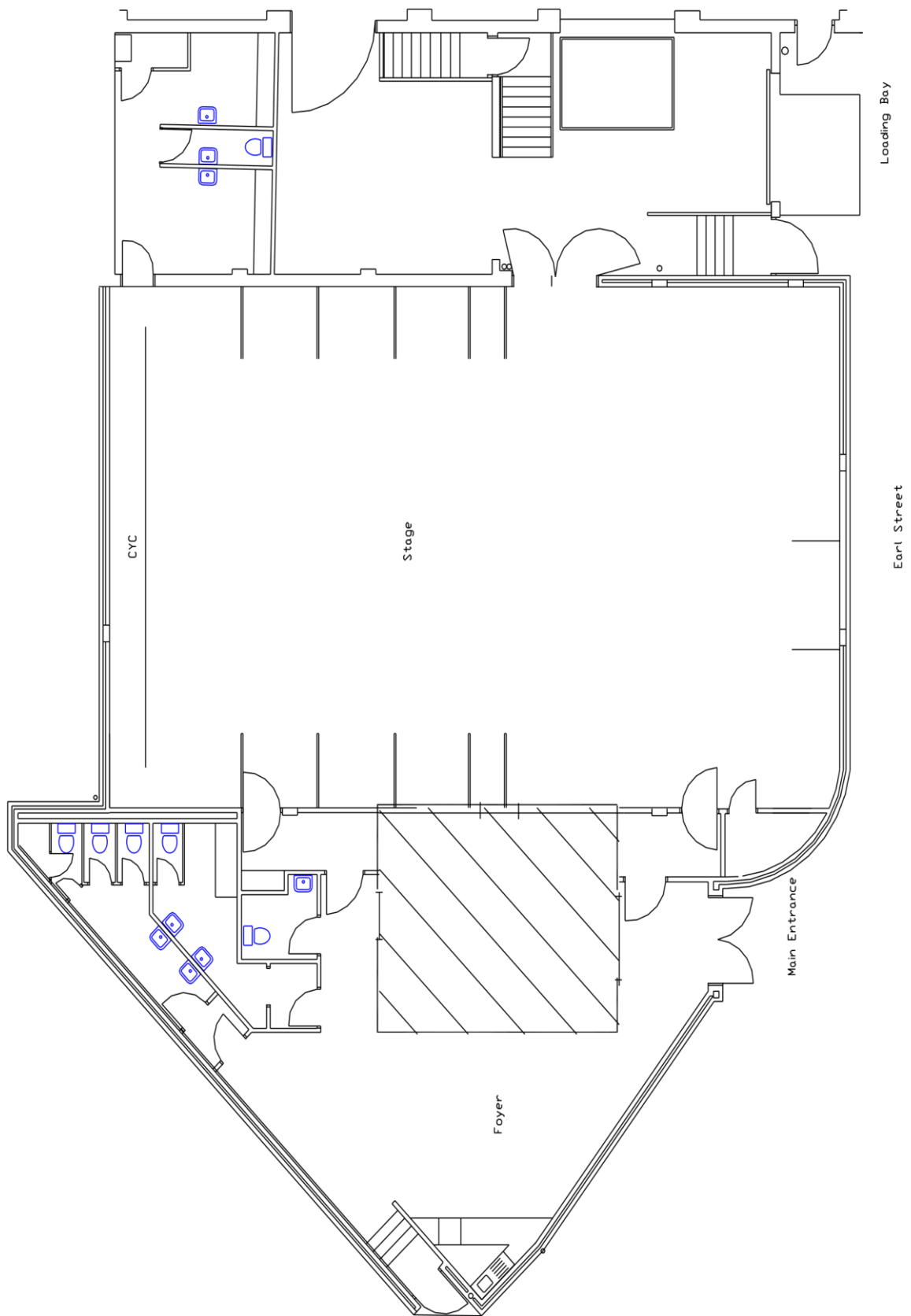

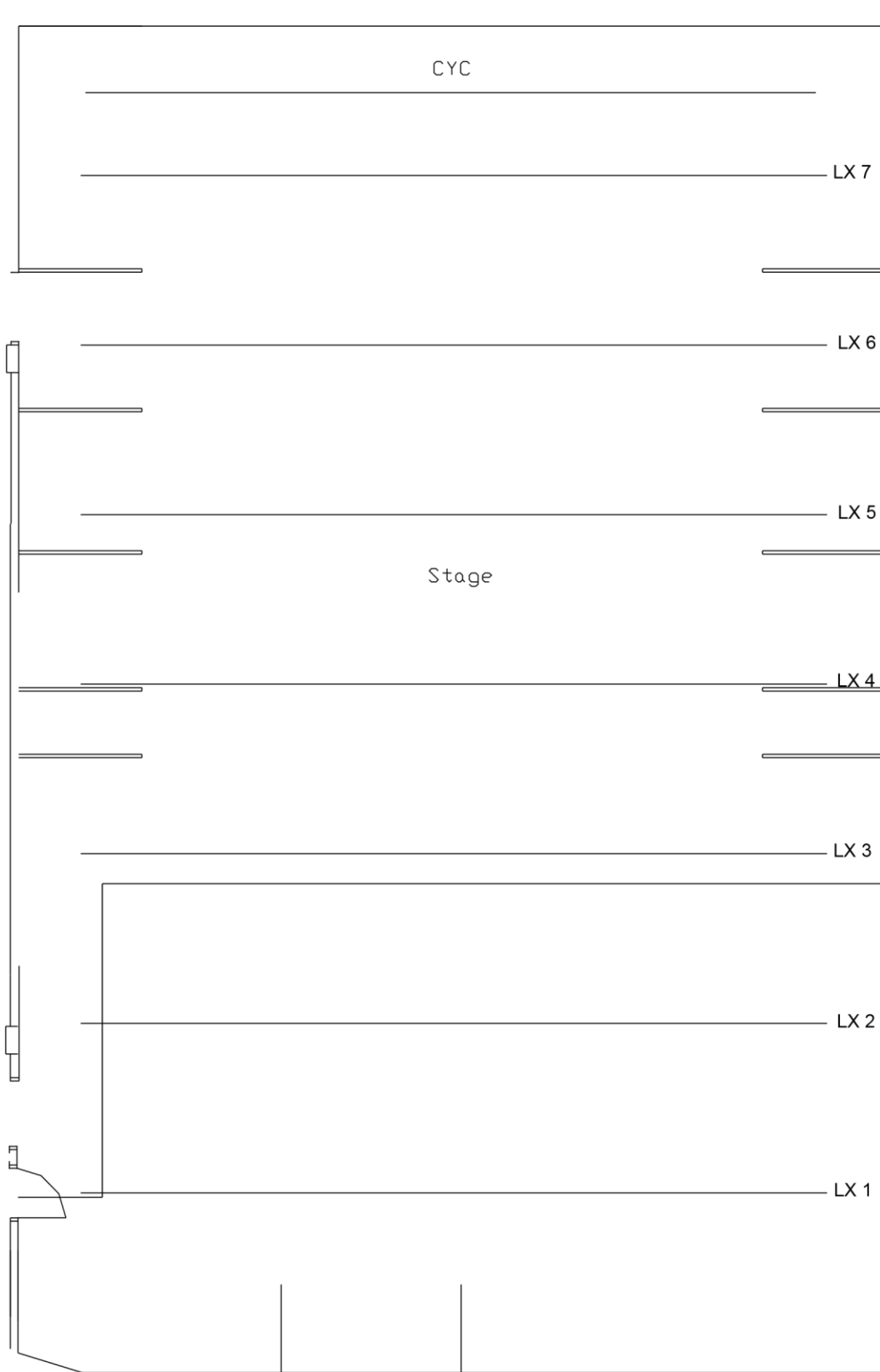

www.theatrenorth.com.au

Earl Street

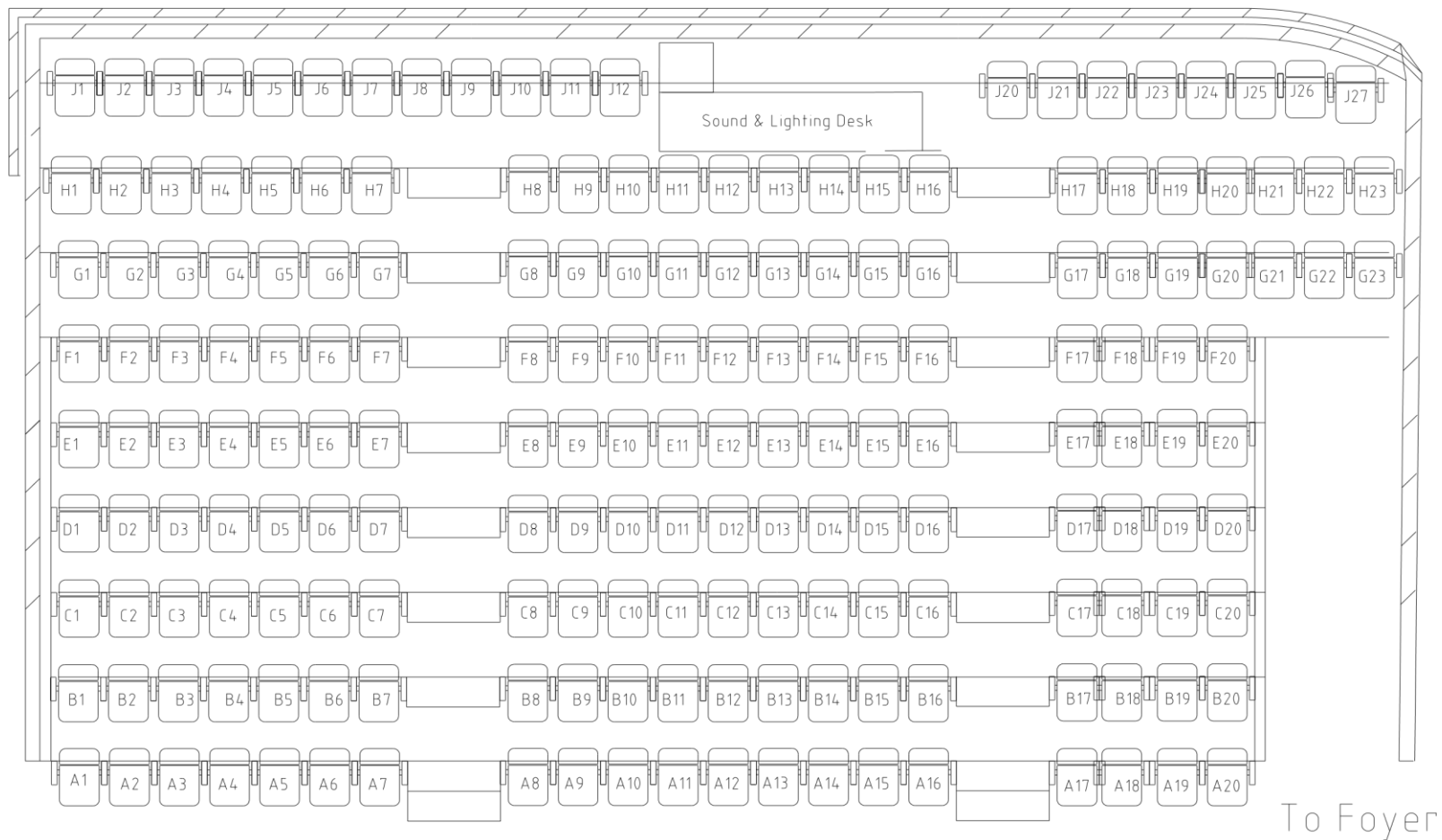

The Earl Arts Centre 186 Seats

Marketing & Publicity Television Stations

Television Stations:

ABC TV: Ann Street, Launceston. Ph: (03) 6332 1030
Southern Cross TV: Watchorn Street, Launceston. Ph: (03) 6344 0202
WIN Television: 136 Hobart Road, Kings Meadows. Ph: (03) 6341 5999

Radio Stations:

ABC Northern Tas: (ABC) Ann Street, Launceston. Ph: (03) 6332 1011
LAFM: (Commercial) York St, Launceston. Ph: (03) 6331 4844
City Park Radio: PO Box 1501, Launceston, Ph: (03) 6334 3344
WAY FM: PO Box 1111, Launceston, Ph: (03) 6334 0100
Triple J: PO Box 9994, Sydney, 2001, Ph: 1900 921 921

Newspapers:

The Examiner: (Launceston based, daily)
Launceston Advertiser
Sunday Examiner LAUNCESTON TAS 7250.
Advertising Ph: (03) 6336 7261
Editorial Ph: (03) 6336 7378

The Mercury: (State-wide, daily)
27 Paterson Street
LAUNCESTON TAS 7250.
Ph: (03) 6331 9144

The Advocate: (North -West, daily)
PO Box 259
DEVONPORT TAS 7310. Ph: (03) 6424 0871

Air Transport:

The airport is situated 12km from the city. Qantaslink, Jetstar and Virgin Blue Airlines service regular flights to all capital cities.

Sea Road:

Most major freight companies service Launceston. Jet Cargo Jet Express daily to all capital cities. **Accommodation:** A large number of hotels and motels are available, all at easy walking distance from the Theatre.

Ask Theatre Management for special accommodation rates at nearby hotels.