



EARL ARTS CENTRE

Venue Information



Images by Melanie Kate Photography

Located at 10 Earl St, Launceston

All enquiries to:
Theatre North
55-57 Brisbane St
LAUNCESTON TAS 7250
P: 03 6331 0052
E: admin@theatrenorth.com.au
W: www.theatrenorth.com.au

Contents

	p
<u>1. MANAGEMENT OF THEATRE</u>	4
Venue Bookings / Enquiries	
Hiring the Earl Arts Centre	
Virtual Tour	
<u>2. EARL ARTS CENTRE: CONTEXT</u>	5
<u>3. FOYER & BAR</u>	6
<u>4. CAPACITY, SEATING, ACCESS</u>	7
Capacity	
Access	
To Assist Access	
<u>5. LOADING BAY, PARKING, STORAGE</u>	8
Loading Bay	
Stage Access	
Parking	
Storage	
<u>6. PERFORMANCE AREA</u>	9
Dimensions	
Drapes	
Stage Fire Precautions	
<u>7. POWER & ELECTRICAL SAFETY</u>	9
3-Phase Power	
Testing & Tagging	
<u>8. LIGHTING</u>	10
Control	
Lamp Stock	
House & Work Lights	
<u>9. AUDIO VISUAL</u>	10
<u>10. AUDIO</u>	11
Control	
PA	
<u>11. STAGE MANAGEMENT & PRODUCTION</u>	11
Stage Management	
Communications (Talkback, Wifi)	
Production Office & Desk	

12. OTHER EQUIPMENT	12
Pianos	
Tables & Chairs	
Music Stands	
Lectern	
13. DRESSING ROOMS	12
14. FRONT OF HOUSE & TECHNICAL STAFF	13
15. MARKETING	13
16. TRANSPORT & FREIGHT	13
17. ACCOMMODATION	13
APPENDICES	20-25
1. Seating Plan	
2. Venue Plan	
3. Auditorium Plan	
4. Distances	
5. Performance Space	



Our Town by Thornton Wilder, Three River Theatre, 2018, image by Megan Casey

1. MANAGEMENT OF THE EARL ARTS CENTRE

The Princess Theatre and Earl Arts Centre are managed by Theatre North Inc, a not-for-profit organisation, on behalf of the City of Launceston.

VENUE BOOKINGS AND ENQUIRIES

For bookings of the Princess Theatre and Earl Arts Centre, please contact:

Theatre North Inc

P: 03 6331 0052

E: admin@theatrenorth.com.au

Visit www.theatrenorth.com.au for our current on-sale calendar.

Special rates are available for community and amateur hires, and corporate events.

HIRING THE EARL ARTS CENTRE

The Earl Arts Centre is a work-horse black box theatre, situated at the rear of the Princess Theatre.

Seating 182, the Earl can be managed up to the level you require.

Hirers are permitted to use their own Front of House and technical teams, subject to training and Theatre North approval.

Other hirers request a full-service management package, including provision of Front of House and Technical staffing at cost.

Hirers are able to utilise self-managed ticketing systems and are not bound to use the Princess Theatre Box Office.

A key will be issued to the Hirer. While Theatre North staff do not need to be present for the term of your hire, Theatre North does encourage strong communication between hirers and management.

VIRTUAL TOUR

A Virtual Tour of the Earl Arts Centre and Princess Theatre is available at theatrenorth.com.au/princess-theatre.

2. EARL ARTS CENTRE: CONTEXT

Since 1993, the Earl Arts Centre has been central to the growth of live performance in Launceston and Northern Tasmania.



image of a Q&A session with Monkey Baa's Possum Magic, 2019.

Built with joint contributions from government, council, community and business, the Earl has carved out a special place in the creative life of the city.

It is heavily utilised by local companies for extended seasons of performance, including new work, classic work, contemporary dance and youth theatre. The venue is also regularly booked for intimate music experiences, cabaret, corporate functions and film nights.

As a contemporary black-box venue, hirers are drawn to its user-friendly nature, its immediacy and its vibe.

For its size, the Earl is technically very well-resourced and can pack a creative punch above its weight.

We look forward to welcoming you.

3. FOYER & BAR

The Earl Arts Centre has a foyer which is suitable for small functions, and can double as an exhibition space.

There is a bar area with fridge, sink, mobile bar and ample shelf space for merchandise display.

The walls have picture rails and track lighting is installed. Wall height is 2930mm.



Please note that Hirers are required to purchase their own liquor license should the bar be in operation. Go to www.treasury.tas.gov.au/liquor-and-gaming to apply.

Theatre North can also operate the bar at cost on behalf of the Hirer.

4. CAPACITY, SEATING & ACCESS



Image by Melanie Kate Photography

CAPACITY

The Earl Arts Centre is licensed to hold 260 people, including staff, performers & crew.

The seating plan is for **182 seats**. Fixed seating is in a front-on, raked bleacher.

See Appendix 1 for a full seating plan, showing aisles, entrance and general arrangement.

Hirers can supply furniture for a cabaret-style performance on the stage.

ACCESS SEATING

Access is flat from the main doors on Earl St to the floor of the auditorium.

Wheelchair seating is available on the floor level, in front of extant seating.

TO ASSIST ACCESS

A Hearing Induction Loop is installed.

A Visual Story outlining expectations of the theatre's geography and operation is available for those who may require it.

5. LOADING BAY, STAGE ACCESS, PARKING & STORAGE

LOADING BAY

The loading bay is situated in Earl St and is shared with the Princess Theatre. Please coordinate your load-in through the Technical Manager. Traffic management can either be provided by a qualified traffic controller or provided by Theatre North at-cost, depending on the time and day of load-in. Please note that Earl St is one way, running from the north (Brisbane St) to the south (York St).

Loading dock is at truck tray height.

Access door to loading bay is 2400 x 2800. Stage door is adjacent to the loading bay.

STAGE ACCESS

Via a sliding sound-proof door at stage level.

Door size: 2400mm x 2400m

The sound-proof door is only to be opened for bump-in/out.

PARKING

The Earl Arts Centre does not have any dedicated car parking spaces available.

Parking is available at Council-owned carparks in Paterson St or privately operated parks in Earl St.

Should parking be required for trucks, please discuss in advance with the Technical Manager.

STORAGE

The Earl Arts Centre has very limited space backstage to store production elements after the hire period. Items can be left for next-day pickup, strictly by arrangement with the Technical Manager.

During the course of the performance season, items can be stored behind the seating bank or in the loading-dock (by arrangement with the Technical Manager). Any items stored in the loading-dock must be arranged neatly and to the satisfaction of the Technical Manager.

6. PERFORMANCE AREA

PERFORMANCE AREA DIMENSIONS

The Earl Arts Centre stage floor is a flat wooden floor mounted on resilient pads, painted Dulux X10 low sheen black. The stage is not to be painted by Hirers.

The stage is a flat floor with no rake.

Auditorium dimensions (inc seating)	13m wide x 20m deep
Performance area dimensions	9.6m wide x 9.7m deep approx
Floor to grid height	5.5m

DRAPES

All theatre walls are black painted concrete block and 50 percent is covered with black curtains on continuous tracking.

White Cyclorama behind rear curtain track: 6m x 13m

House curtain: burgundy, French action, operated from PS.

There are NO flies.

STAGE FIRE PRECAUTIONS

Any scenery, props, masking etc must be rendered non-flammable to the approval of Princess Theatre management.

No scenery, props, masking etc shall be placed in such a manner as to hinder the safe evacuation of the building in the event of an emergency.

7. POWER & ELECTRICAL SAFETY

Power is keyed near the main entrance to the Foyer. The foyer fridge runs off a separate circuit.

3-PHASE POWER

1 x 3 phase 32A outlet located in the patch bay

TESTING & TAGGING

The Princess Theatre adheres to Australian Standard AS/NZS 3760

Note: all electrical appliances and power leads should be tested and tagged with inspection date and due date displayed.

8. LIGHTING

CONTROL

Lighting Desk: MA 3 on PC and Control Wing
60 x 2.4 Kw LSC dimmers capable of true power switching

5 x motorised lighting bars - Tri Truss, 20 outlets wired to patch room.
2 x motorised lighting bars (Bars 3 and 4) - 18 outlets wired to patch room.
Height from stage floor to LX bars 5.5m
All bars have 2 x DMX and 2 x Cat 6 wired to patch room
The lighting bars have a safe working load (SWL) of 250kg
2 x DMX Splitters

LAMP STOCK

16	1.2k Selecon SF Fresnels with barn doors
6	1.2k Selecon PC with barn doors
10	Ovation Reve E-3 RGB RB A Mint 25° – 50° Lens
12	1k 23° /50° Selecon Pacific Profile
20	Tourpro slimpar 18 RGBAW-UV
14	650 watt Phida Fresnels (with barn doors)
4	650 watt Selecon Acclaim Profiles 24° – 44°
10	650 watt Selecon Profiles Zoom Spot 24° – 40°
16	Par 64 MFL

Additional lighting equipment may be available from the Princess Theatre, by arrangement with the Technical Manager. This includes boom stands, hazers, additional scaff etc.

HOUSE & WORK LIGHTS

House lights (QIs) are operated from the lighting and sound desk.
Stage work lights are controlled from patch room.
Fluorescent work lights over the audience seating are controlled from the lighting and sound desk.

9. AUDIO-VISUAL

Available by request.
To request price and availability please contact admin@theatrenorth.com.au

PROJECTORS	
1	Sony ultra-wide data projector 3000 lumens with flying brackets
1	Sanyo data projector 15000 Ansi Lumens
SCREEN	
1	Fast fold screen front and rear screens, leg and full drape kit 12 x 9 feet (4:3) can be draped to 12 x 6.75 feet (16:9)

10. AUDIO

CONTROL

1	DIGICO S31 Digital audio Desk 24 inputs 12 outputs
1	Digico D-Rack 32 inputs 16 outputs (on request)

PA

2	JBL EON 15P Music Mix powered speakers FOH
2	JBL Fold Back speakers and Amp
2	JBL microphones
2	microphone stands with boom arms
1	Sony 5 stack CD player

Additional audio equipment may be available from the Princess Theatre, by arrangement with the Technical Manager. This includes microphones etc.

11. STAGE MANAGEMENT & PRODUCTION

STAGE MANAGEMENT

The Earl Arts Centre does not have a dedicated position for stage management. Shows are often called from the lighting and sound desk at rear of seating.

COMMUNICATIONS

TALKBACK

Jands Ezicom system.

Outlets at prompt, opposite prompt, sound and lighting desk, back wall up stage and patch bay. Headsets and belt pack available on request.

WIFI

Free internet access is available through the City of Launceston visitor Wifi network. No password is required.

There is no paging equipment to the dressing rooms or foyer.

PRODUCTION OFFICE

No dedicated production office is available.

Should your production require administrative services, such as printing or photocopying, please make contact with management: admin@theatrenorth.com.au

A production desk with lamp, talkback, microphone, power can be set up inside the auditorium.

12. OTHER EQUIPMENT

Please discuss your requirements in advance with the Theatre North technical team.

PIANOS

1	7'6" 3/4 Alex Steinbach Grand, model SG 225
1	upright Steck

Please note that charges apply for piano hire and tuning

TRESTLE TABLES

3 grey trestle tables, which are stored underneath the seating bank. Additional tables may be available from the Princess Theatre upon request.

CHAIRS

Approx 60 burgundy chairs are available for use. Stored underneath the seating bank.

MUSIC STANDS

10 orchestral music stands are available by arrangement.

LECTERN

One black lectern is available with microphone and sconces, by arrangement. It has a soft front panel for branding.

13. DRESSING ROOMS

Two dressing rooms (with shared unisex toilet) at stage level.

Total accommodation: 6

Dressing rooms have mirrors and hand basins, and an ironing board.

Please note that the Earl Arts Centre does not have green room or shower facilities.

14. FRONT OF HOUSE & TECHNICAL STAFF

Hirers are able to provide their own Technical and FOH staff.

Volunteer FOH staff **must** have a briefing with Theatre Management before working any performances or events.

Likewise, visiting production crews **must** have a technical and safety briefing prior to the commencement of the hire.

Princess Theatre casual Front of House and/or Technical staff is available at cost to the Hirer.

For queries, please contact Theatre North at admin@theatrenorth.com.au

15. MARKETING

Please contact the Theatre North team to discuss assistance with marketing.

E: admin@theatrenorth.com.au

Northern Tasmania is serviced by three local TV newsrooms, ABC Local Radio, two commercial radio stations and several community radio stations, along with three Tasmanian newspaper mastheads.

Current media contact lists and in-venue marketing packages are appended to the Venue Hire Contract and are also available on request.

16. TRANSPORT & FREIGHT

AIRPORT

Launceston Airport is situated 12km from the city. Qantas, Virgin Australia and Jetstar service regular flights to most capital cities and some regional airports.

Transport into the city is possible by hire car, taxi, rideshare companies and shuttle bus services.

FREIGHT

Most major freight companies service Launceston, including air and sea cargo.

17. ACCOMMODATION

Theatre North can offer competitive accommodation packages through its partnership with the [Hotel Grand Chancellor Launceston](#); a 4.5 star hotel just 4 minutes walk from Stage Door.

Additionally, the Princess Theatre is within easy walking distance of several other quality hotels and restaurants.

APPENDIX 1: Earl Arts Centre Seating Plan

Full CAD plans available on request
182 pax

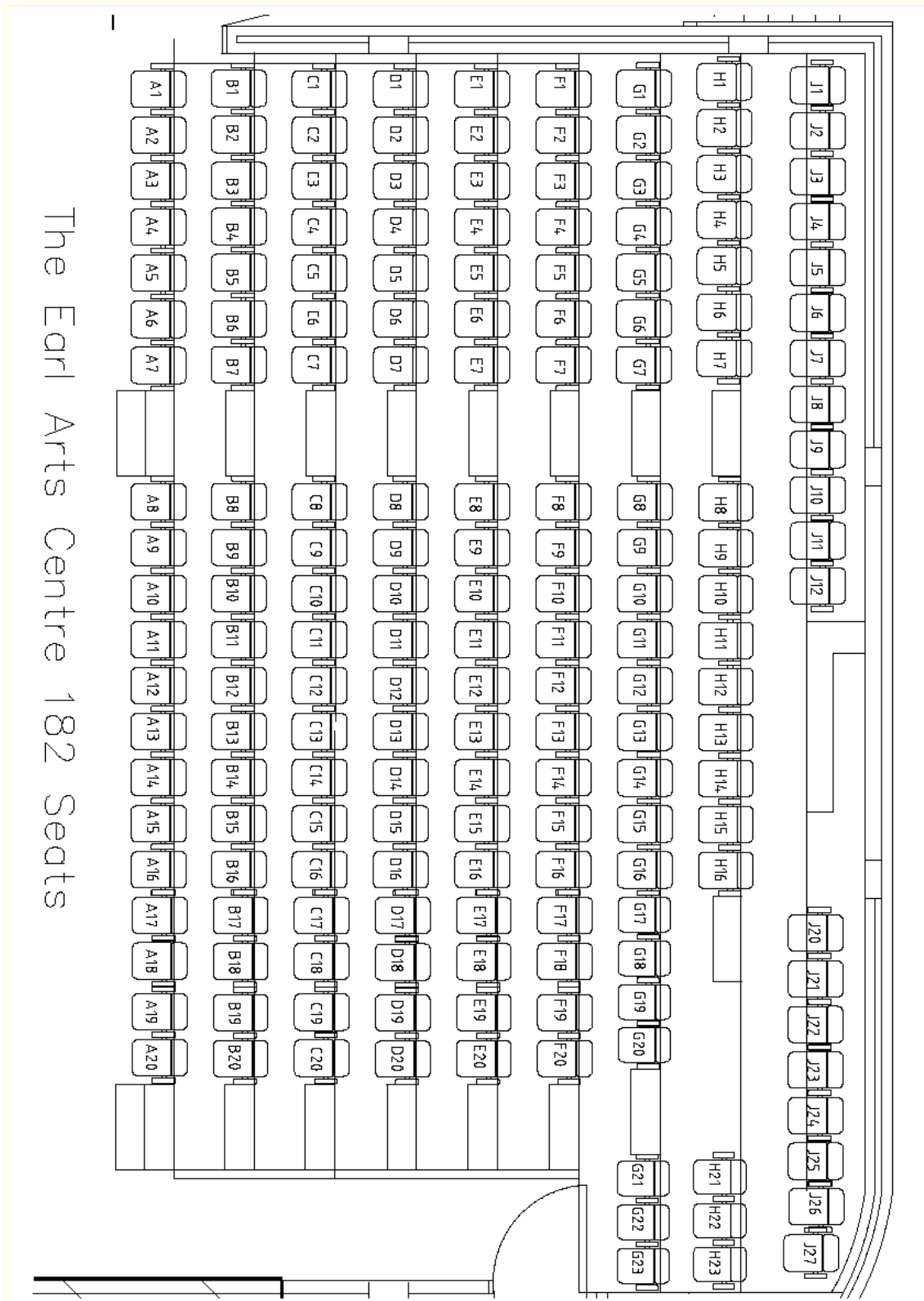

APPENDIX 2: Venue Plan

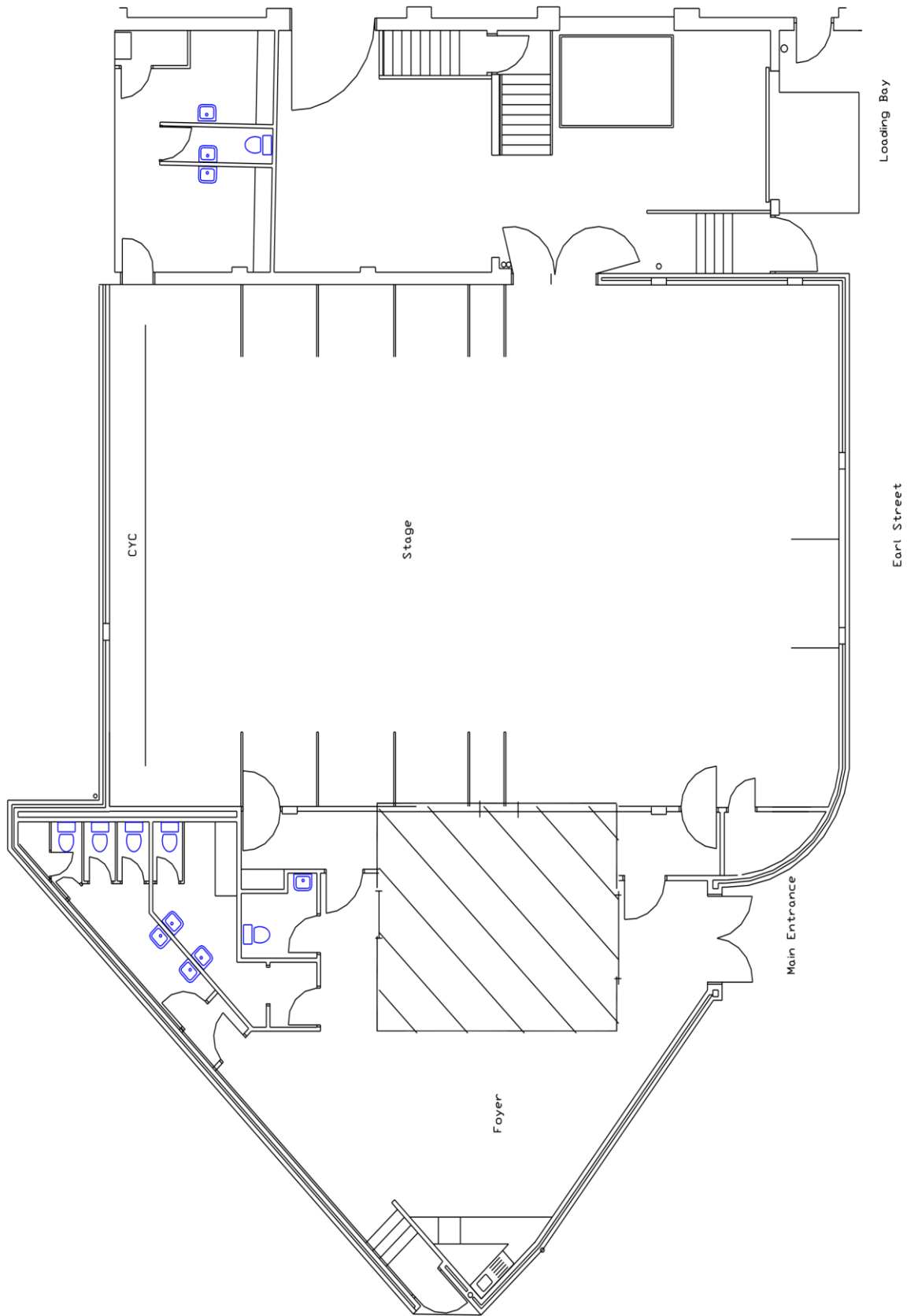

APPENDIX 3: Auditorium Plan

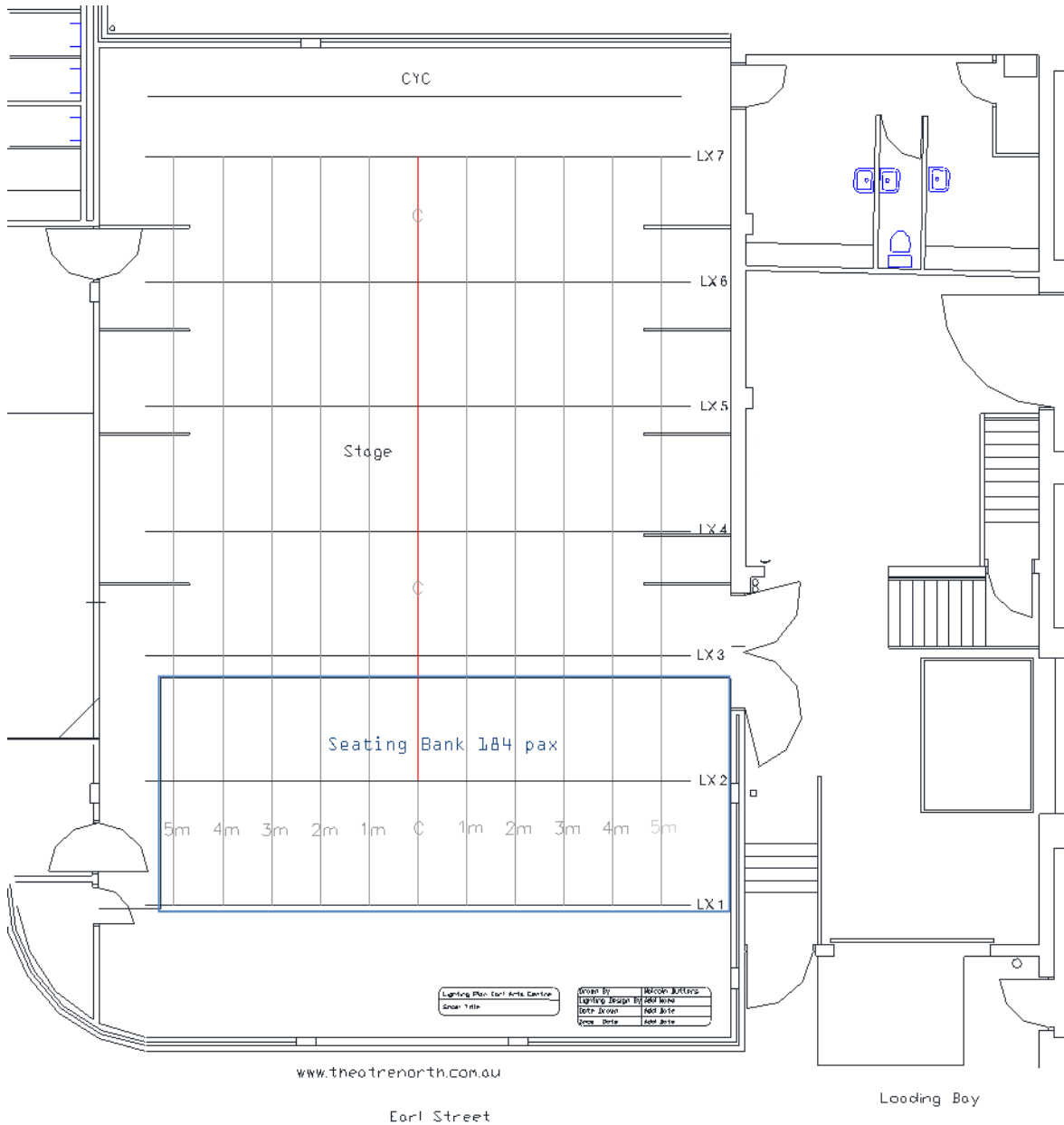

APPENDIX 4: Distances

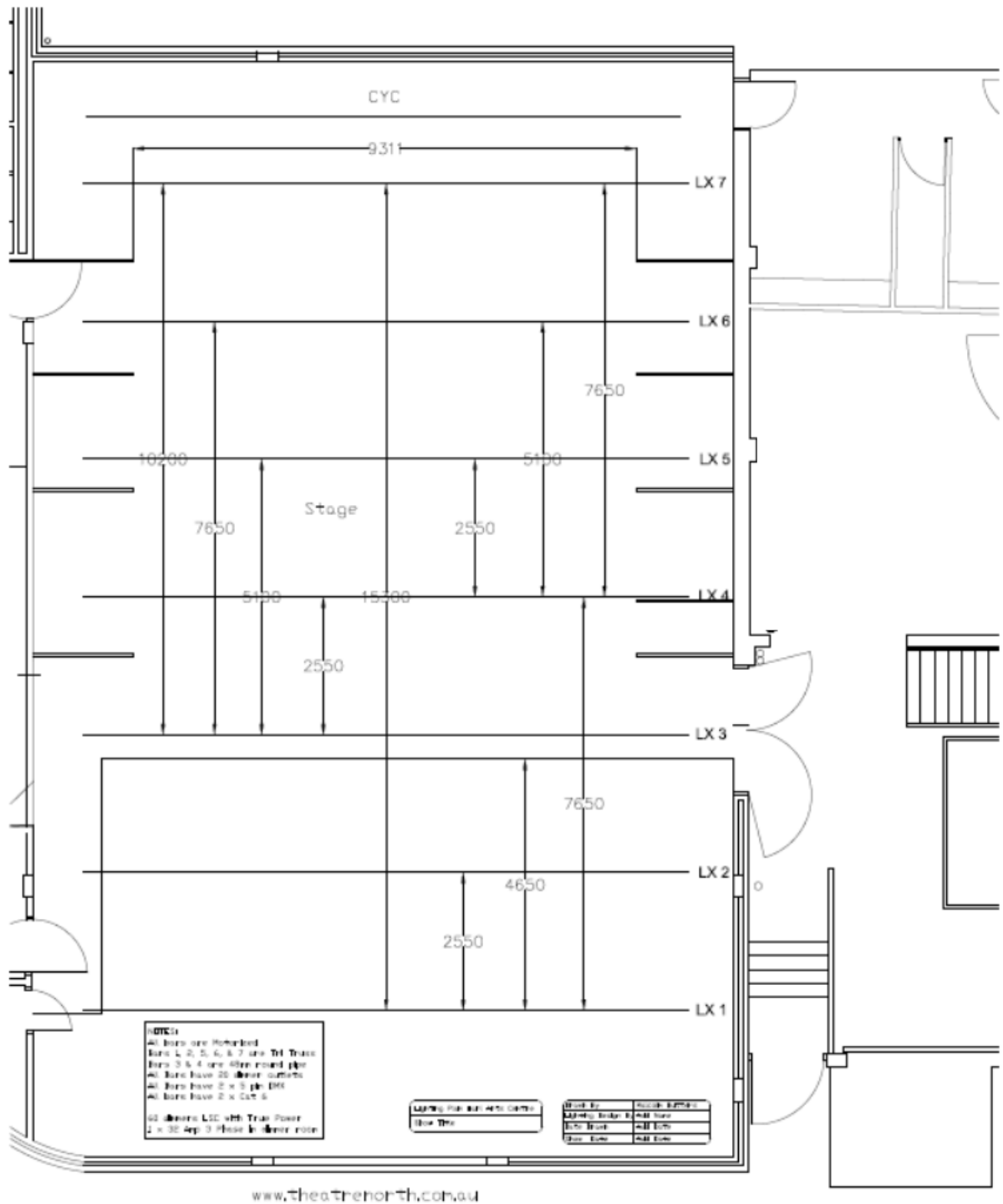

APPENDIX 5: PerformanceSpace

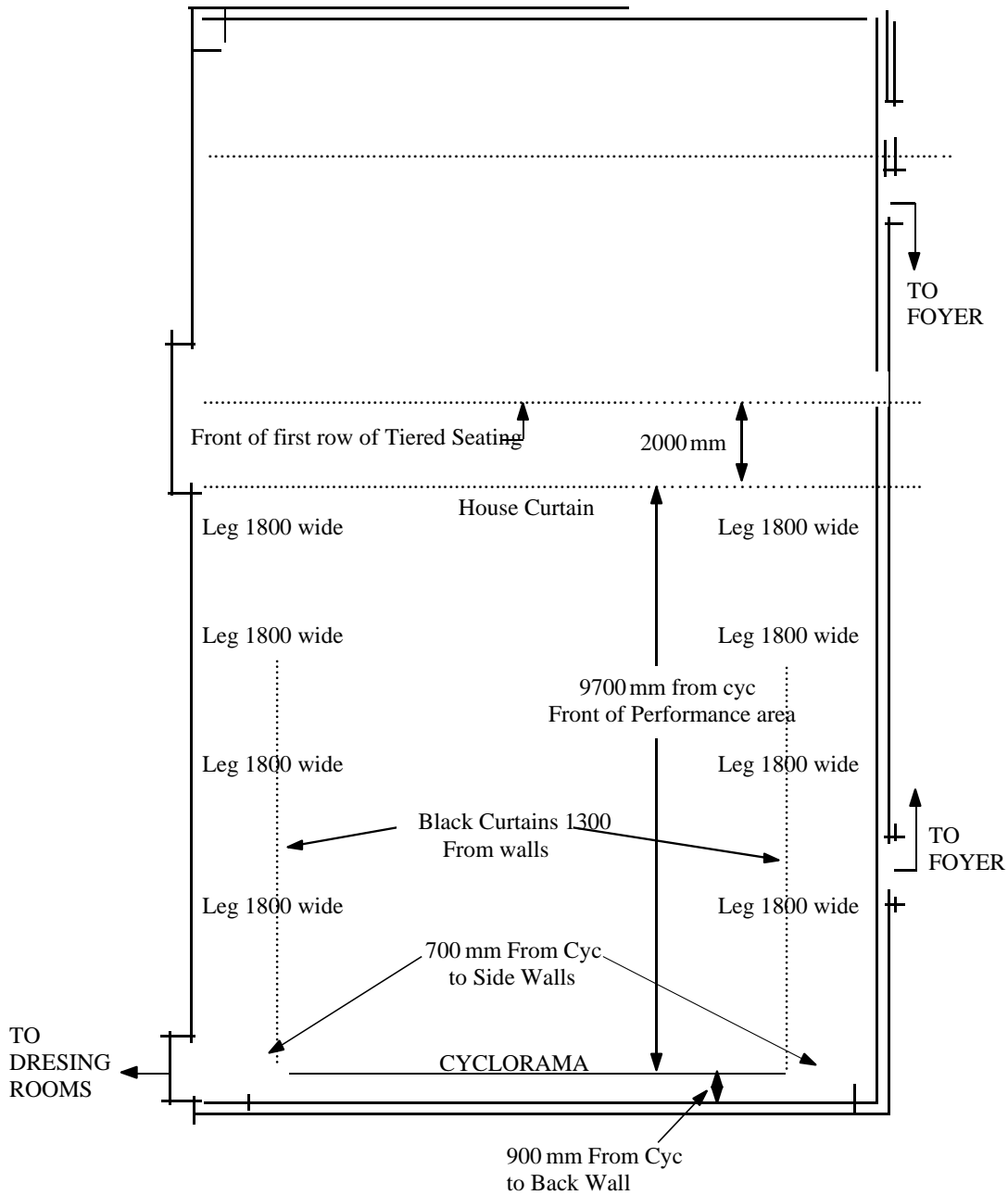

APPENDIX 6: Standard Lighting

Full CAD plans available on request

